

SMT LEDs

0603 Series

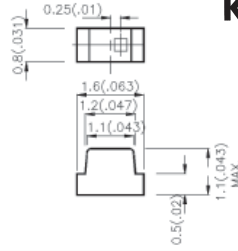

Part No.	Colour	Viewing Angle	Luminous Intensity	U _F [V]
KP-1608 ID	red	120°	12mcd/20mA	2,0
KP-1608 MBC	blue	120°	10mcd/20mA	3,8
KP-1608 SGD	green	120°	12mcd/20mA	2,2
KP-1608 YD	yellow	120°	8mcd/20mA	2,1

Part No.	Ord. No.
S KP-1608 ID	41171
S KP-1608 MBC	41163
S KP-1608 SGD	41172
S KP-1608 YD	41173

Package: 2000pcs

0805 Series

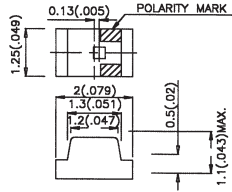
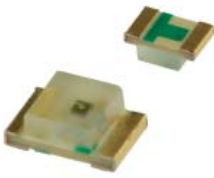

Part No.	Colour	Viewing Angle	Luminous Intensity	U _F [V]
KP-2012 EC	red	120°	12mcd/20mA	2,0
KP-2012 MBC	blue	120°	10mcd/20mA	3,8
KP-2012 PBC-A	blue	120°	45mcd/20mA	3,65
KP-2012 SGC	green	120°	15mcd/20mA	2,2
KP-2012 SYCK	yellow	120°	12mcd/20mA	2,0
KP-2012 SYC	yellow	120°	100mcd/20mA	2,0

Part No.	Ord. No.
S KP-2012 EC	12660
S KP-2012 SGC	12659
S KP-2012 SYCK	59713
S KP-2012 MBC	41165
O KP-2012 PBC-A	12103
S KP-2012 SYC	47004

Package: 2000pcs

1206 Series

KP

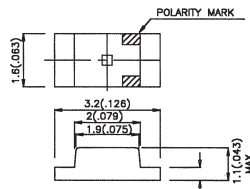

Part No.	Colour	Viewing Angle	Luminous Intensity	U _F [V]
KP-3216 EC	red	120°	12mcd/20mA	2,0
KP-3216 MBCK	blue	120°	8mcd/20mA	4,0
KP-3216 PBC-A	blue	120°	10mcd/20mA	3,8
KP-3216 SGC	green	120°	15mcd/20mA	2,2
KP-3216 SYCK	yellow	120°	120mcd/20mA	2,0
KP-3216 YC	yellow	120°	8mcd/20mA	2,1

Part No.	Ord. No.
S KP-3216 EC	12661
S KP-3216 SGC	12671
S KP-3216 YC	12630
S KP-3216 MBCK	49820
S KP-3216 PBC-A	41166
S KP-3216 SYCK	56539

Package: 2000pcs

Kingbright

Kingbright

KPTD

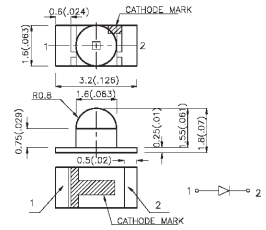

Part No.	Colour	Angle	Luminous Intensity	U _F [V]
KPTD-3216 SRC-PRV	red	50°	300mcd/20mA	1,85
KPTD-3216 YC	yellow	40°	30mcd/20mA	2,1

Part No.	Ord. No.
S KPTD-3216 SRC-PRV	45180
S KPTD-3216 YC	45181

Package: 2000pcs

Surface Mount LEDs Kit



Ring binder surface mount LED Kit
1206 case sizes
Kit contains 4 types of SMD LEDs /270 pieces

Part No.	Ord. No.
S SET SMD LED 1206	51654

PLCC2 Series

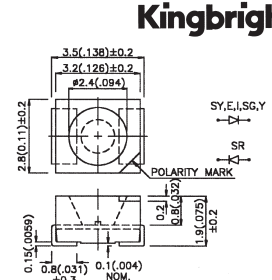

Part No.	Colour	Angle	Luminous Intensity	U _F [V]
KA-3528A LSRC	red	120°	8mcd/2mA	1,65
KA-3529 SES-L1	red	120°	6000mcd/150mA	2,9
KA-3528A SRC	red	120°	150mcd/20mA	1,85
KA-3528A SURC-E	red	120°	280mcd/20mA	1,9
KA-3528A MBC	blue	120°	15mcd/20mA	3,8
KA-3528A PBC-G	blue	120°	200mcd/20mA	3,2
KA-3529 QB24ZS	blue	120°	1500mcd/150mA	3,5
KA-3528A LSGC	green	120°	2mcd/2mA	1,9
KA-3528A VGC-A	green	120°	220mcd/20mA	3,2
KA-3528A SGC	green	120°	25mcd/20mA	2,2
KA-3529 ZG24ZS	green	120°	7500mcd/150mA	3,4
KA-3529 SYS-L1	yellow	120°	3000mcd/150mA	2,8
KA-3528A SYC	orange	120°	180mcd/20mA	2,0

L-T670 LBCT-PO	blue	ECONOMIC
L-T670WDT-PO	white	ECONOMIC

Part No.	Ord. No.
S KA-3528A LSGC	12116
S KA-3528A LSRC	12054
S KA-3528A MBC	12405
S KA-3528A PBC-G	59941
S KA-3528A VGC-A	64794
S KA-3529 QB24ZS	69388
S KA-3529 SES-L1	70560
S KA-3529 SYS-L1	70561
S KA-3528A SGC	12696
S KA-3528A SRC	12231
S KA-3528A SURC-E	48756
S KA-3528A SYC	58045
S KA-3529 ZG24ZS	69389
S L-T670 LBCT-PO	64504
S L-T670WDT-PO	64253