

8mm Series

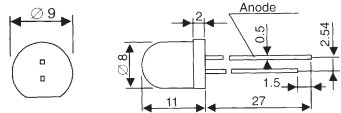

Kingbright

| Part No. | Colour | Viewing Angle | Luminous Intensity | U _F [V] |
|-------------|--------|---------------|--------------------|--------------------|
| L-793 ID | red | 60° | 100mcd/20mA | 2,00 |
| L-793 SRD-B | red | 60° | 200mcd/20mA | 1,85 |
| L-793 GD | green | 60° | 60mcd/20mA | 2,20 |
| L-793 YD | yellow | 60° | 50mcd/20mA | 2,10 |
| L-793 ED | orange | 60° | 100mcd/20mA | 2,00 |

| Part No. | Ord. No. |
|---------------|----------|
| S L-793 ID | 12384 |
| S L-793 SRD-B | 12394 |
| S L-793 GD | 12385 |
| S L-793 YD | 12386 |
| S L-793 ED | 12387 |

10mm Series

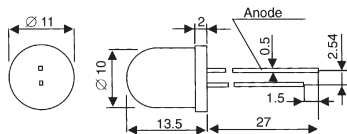

Kingbright

| Part No. | Colour | Viewing Angle | Luminous Intensity | U _F [V] |
|-------------|-------------|---------------|--------------------|---------------------|
| L-813 ID | red | 60° | 100mcd/20mA | 2,00 |
| L-813 SRD-E | red | 60° | 450mcd/20mA | 1,85 |
| L-813 GD | green | 60° | 60mcd/20mA | 2,20 |
| L-813 SGC | green clear | 40° | 500mcd/20mA | 2,20 |
| L-813 YD | yellow | 60° | 50mcd/20mA | 2,10 |
| L-813 ED | orange | 60° | 100mcd/20mA | 2,00 |
| LED10MMBLAU | blue | | 3500mcd/20 | ECONOMIC 3,6 |

| Part No. | Ord. No. |
|---------------|----------|
| S L-813 ID | 12190 |
| S L-813 SRD-E | 12316 |
| S L-813 GD | 12248 |
| S L-813 SGC | 11972 |
| S L-813 YD | 12253 |
| S L-813 ED | 12373 |
| S LED10MMBLUE | 44759 |

20mm Series

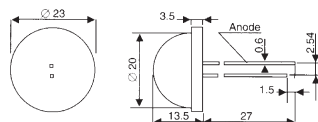

Kingbright

| Part No. | Colour | Viewing Angle | Luminous Intensity | U _F [V] |
|------------|--------|---------------|--------------------|--------------------|
| DLC2-6 ID | red | 120° | 50mcd/10mA | 1,9 |
| DLC2-6 SRD | red | 120° | 400mcd/20mA | 1,85 |
| DLC2-6 GD | green | 120° | 80mcd/10mA | 2 |
| DLC2-6 SGD | green | 120° | 200mC/20mA | 2,2 |
| DLC2-6 YD | yellow | 120° | 50mcd/10mA | 1,95 |

| Part No. | Ord. No. |
|--------------|----------|
| S DLC2-6 ID | 11937 |
| S DLC2-6 SRD | 12302 |
| S DLC2-6 GD | 11951 |
| S DLC2-6 SGD | 12301 |
| S DLC2-6 YD | 11955 |

Super Bright LEDs

3mm Super Bright Series

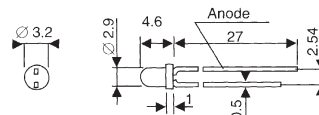

Kingbright

| Part No. | Colour | Viewing Angle | Luminous Intensity | U _F [V] |
|-------------|--------|---------------|--------------------|--------------------|
| L-934 SEC-H | red | 50° | 500mcd/20mA | 2,20 |
| L-934 SRC-C | red | 50° | 500mcd/20mA | 1,85 |
| L-934 SYC | yellow | 50° | 700mcd/20mA | 2,00 |
| L-934 SYC-H | yellow | 50° | 900mcd/20mA | 2,30 |
| L-934 VGC-Z | green | 50° | 2000mcd/20mA | 4,00 |

| Part No. | Ord. No. |
|---------------|----------|
| S L-934 SEC-H | 45253 |
| S L-934 SRC-C | 12331 |
| S L-934 SYC | 12622 |
| O L-934 SYC-H | 49045 |
| S L-934 VGC-Z | 70585 |

ECONOMIC

| Part No. | Colour | Viewing Angle | Luminous Intensity |
|-----------------|--------|---------------|--------------------|
| HSBL-3101L | blue | 40° | 1000mcd/20mA |
| LED 3MM BL | blue | 30° | 3500mcd |
| LED 3MM GN | green | 30° | 300mcd |
| LED 3MM RD | red | 30° | 1000mcd |
| LED 3MM YE | yellow | 30° | 1500mcd |
| LED 3MM WH | white | 30° | 1000mcd |
| LED 3MM GN PURE | green | 30° | 6000mcd |
| L3-B71GWL | blue | 15° | 2000mcd/20mA |

| Part No. | Ord. No. |
|-------------------|----------|
| S HSBL-3101L | 51849 |
| S LED 3MM BL | 57609 |
| S LED 3MM GN | 57610 |
| S LED 3MM RD | 57616 |
| S LED 3MM YE | 57617 |
| S LED 3MM WH | 57618 |
| S LED 3MM GN PURE | 59599 |
| S L3-B71GWL | 44704 |

5mm Super Bright Series

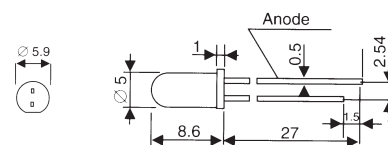

Kingbright

| Part No. | Colour | Viewing Angle | Luminous Intensity | U _F [V] |
|---------------|--------|---------------|--------------------|--------------------|
| L-53 SEC-E | red | 30° | 5000mcd/20mA | 2,00 |
| L-53 SEC-H | red | 30° | 10000mcd/20mA | 2,20 |
| L-53 SRC-D-W | red | 30° | 1700mcd/20mA | 1,85 |
| L-53 SRC-F | red | 30° | 4000mcd/20mA | 1,85 |
| L-53 SRC-C | red | 60° | 1000mcd/20mA | 1,85 |
| L-53 SRC-E | red | 60° | 2800mcd/20mA | 1,85 |
| L-7524 SEC-H | red | 12° | 7500mcd/20mA | 2,20 |
| L-7113 SEC-H | red | 20° | 1000mcd/20mA | 2,20 |
| L-7113 PBC-H | blue | 16° | 3600mcd/20mA | 3,80 |
| L-7524 PBC-Z | blue | 18° | 3300mcd/20mA | 3,80 |
| L-53 VGC-E | green | 30° | 4500mcd/20mA | 4,00 |
| L-7113 TGC | green | 20° | 1500mcd/20mA | 3,60 |
| L-7113 VGC-E | green | 20° | 3000mcd/20mA | 3,50 |
| L-7524 VGC-Z | green | 12° | 13000mcd/20mA | 3,20 |
| L-53 SYT | yellow | 30° | 1200mcd/20mA | 2,00 |
| L-7113 SYC-J2 | yellow | 20° | 3800mcd/20mA | 2,30 |