

5,7" Screen Size

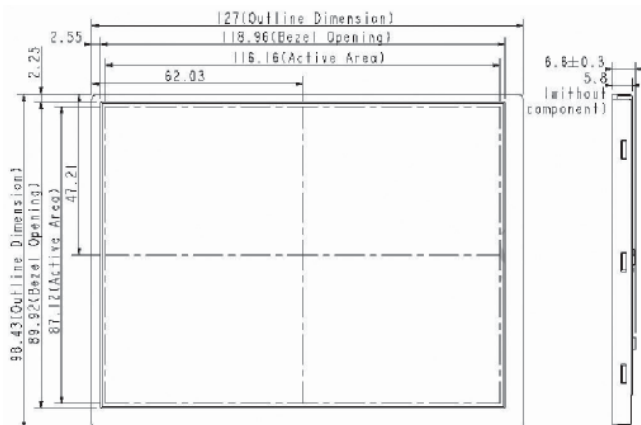

TFT modules 5,7" diagonal
LVDS input interface
+5V single power supply
LED backlight



Part No.	Module Dimensions (mm)	Active Area (mm)	Displst Format (mm)
BT 5.7 ADNHW	127x98,5x6,6	116,16x87,12	640x480

Part No.	Ord. No.
BT 5.7 ADNHW	67811

3,5" Screen Size



TFT modules 3,5" diagonal
NTSC/PAL signal input
CVBS/S video input
+12V single power supply
LED backlight

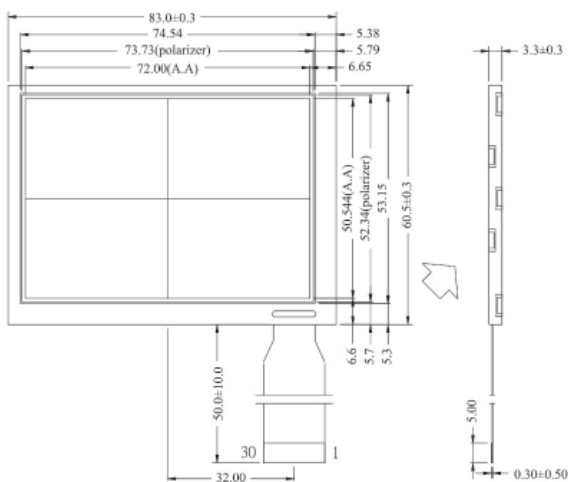

Part No.	Module Dimensions (mm)	Active Area (mm)	Displst Format (mm)
BT 3.5 B ACHB	83x60,5x3,3	72x50,5	480x234

Part No.	Ord. No.
BT 3.5 B ACHB	63717

2,5" Screen Size



TFT modules 2,5" diagonal
NTSC/PAL signal input
CVBS/S video input
+12V single power supply
LED backlight

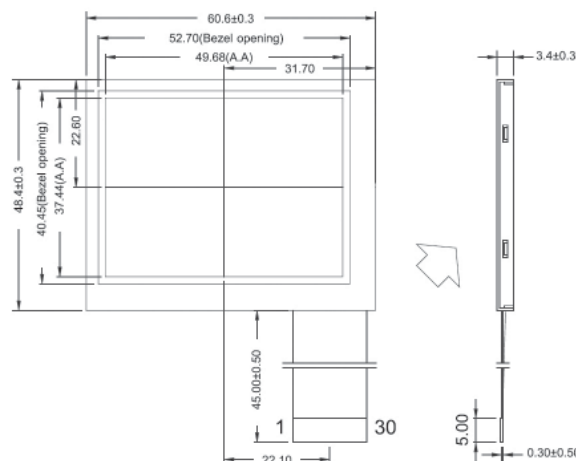

Part No.	Module Dimensions (mm)	Active Area (mm)	Displst Format (mm)
BT 2.5A HB	60,6x48,4,5x3,4	79,68x37,44	480x234

Part No.	Ord. No.
BT 2.5 AHB	63716

Display Accessories

Bezels

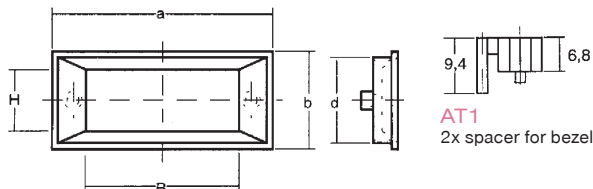

AT1
2x spacer for bezel

Part No.	Description
AR1938	Bezel for 3-digit LCD/LED display with 13mm characters B=38mm, H=19mm, a=59mm, b=32mm, d=28mm
AR1950	Bezel for 4-digit LCD/LED display with 13mm characters B=50mm, H=19mm, and=70mm, b=32mm, d=28mm
AT 1 (pair)	Spacer for LED/LCD frame

Part No.	Ord. No.
S AR1938	2069
S AR1950	11254
S AT 1 (pair)	11255

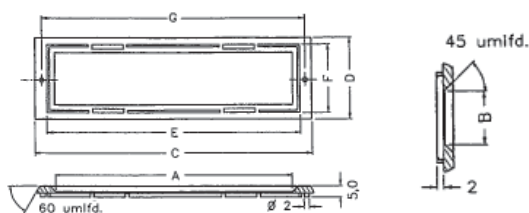

Part No.	Description
FR 919.040	Plastic bezel for LCD module 16x2, black A=60mm, B=14,8mm, C=76mm, D=27mm, E=66,2mm, F=21,2mm, G=71mm

Part No.	Ord. No.
S FR 919.040	7587