

## DIP xx 1A

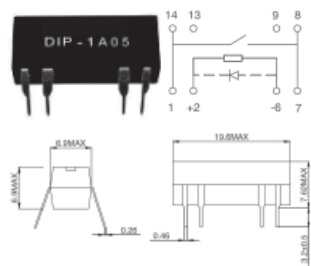

## SIL xx 1A

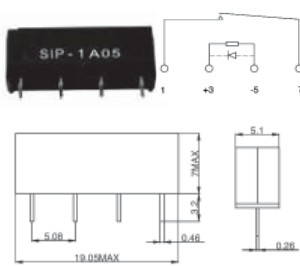

ECONOMIC

Technical Parameters	DIP xx 1A	SIL xx 1A
Contacts Type	SPST-NO	SPST-NO
Max. Switching Power	10 W	10 W
Max. Switching Current	0,5 A	0,5 A
Max. Switching Voltage	100 VDC	100 VDC
Operate/Release Time	0,5 ms / 0,5 ms	0,5 ms / 0,5 ms
Package	DIL	SIL

Part No.	Ord. No.	Description
S DIP 05-1A	52715	5V 500R
S DIP 12-1A	52716	12V 1000R
S SIL 05-1A	52717	5V 500R
S SIL 12-1A	52718	12V 1000R

## Reed Switches and Magnets

Reed switches consist of two ferromagnetic blades of iron and nickel, hermetically sealed in a glass capsule. The switches are actuated through the introduction or removal of a magnetic field and are for use in wet and dirty environments.

## KSK

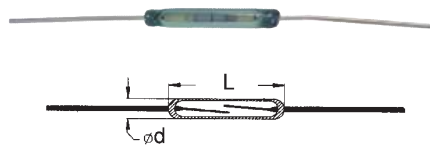

MEDER electronic

Technical Parameters	KSK-1A52	KSK-1A66
Contacts Type	SPST-NO	SPST-NO
Max. Switching Power	50 W	10 W
Max. Switching Current	0,5 A	0,5 A
Max. Switching Voltage	250 VDC	200 VDC
Dimensions	21 x 2,75 mm	14 x 2,2 mm

Part No.	Ord. No.
S KSK-1A52-3040	4614
S KSK-1A66-1020	2307

Technical Parameters	KSK-1A87	KSK-1C90
Contacts Type	SPST-NO	SPDT
Max. Switching Power	10 W	20 W
Max. Switching Current	0,5 A	1 A
Max. Switching Voltage	200 VDC	175 VDC
Dimensions	10 x 2 mm	14 x 2,54 mm

Part No.	Ord. No.
S KSK-1A87-1520	2475
O KSK-1C90-1520	47547

## MK 67 B

magnetically operated reed proximity switch for direct PCB mounting. The sensor should be mounted on a fixed surface with the actuating magnet on the moving surface.

Introduction or removal of the magnetic field determines the closing and opening of the reed switch.

SPST-NO  
0,5A, 10W



MEDER electronic

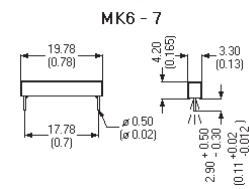

Part No.	Ord. No.
S MK 67 B	6690

## MK3-3A71B-500W

magnetically operated reed proximity switches in a cylindrical case with an interconnect cable.

SPST-NO, 0,5A, 10W



## MK4-1A71B-500W

reed switch SPST-NO, 0,5A, 10W, with cable. Mate: MM4.

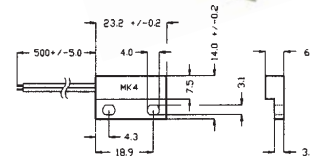

Part No.	Ord. No.
S MK03-1A66B-500W	23778
S MK4-1A66B-500W	5239

## MM 4

Magnet 23x14mm, for MK4, material AlNiCo 500.



## MM 312

Magnet diameter 3mm, length 12mm, material AlNiCo 500.



Part No.	Ord. No.
S MM 4	6689
S MM 312	6687

## Level Sensors

MEDER electronic

Standard liquid level sensor for water applications and dilute acids. Prichytáva sa maticou. The standard termination is a PVC cable with a cross section of 0.14 mm<sup>2</sup> and a length of 500 mm.

### APPLICATIONS

Liquid container monitoring in household, appliances, automotive applications, test and measurement, and control technology.

### LS02

Standard liquid level sensor. The sensor has to be mounted vertically for best result.

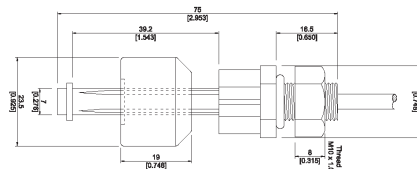

Part No.	Ord. No.
S LS02-1A66-PP-500W	5487

### LS03

Standard liquid level sensor. The sensor has to be mounted horizontally for best results.

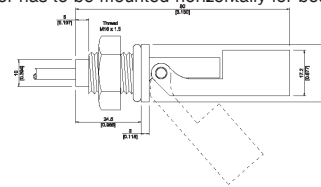

Part No.	Ord. No.
S LS03-1A66-PP-500W	5488

## Movement Switch

### CW 1300-0

Movement switch, mercury free. Max. 60V/0,25A. 3VA, activation angle 15°.

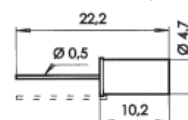

Part No.	Ord. No.
S CW1300-0	1444