

Thermal Fuses

Non-resettable

TSM xxx BF

Thermal fuses, radial situated pins, PCB mounting. Max. 250V / 2A.
Temperature tolerance 10%.



Part No.	Ord. No.		
S TSM 102 BF	56196	102°C	
S TSM 115 BF	50987	115°C	
S TSM 125 BF	55563	125°C	
S TSM 130 BF	50988	130°C	

G 4 A xxx

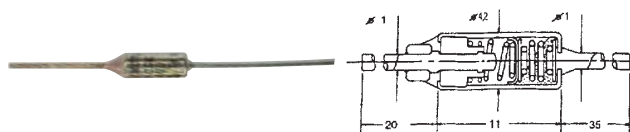

Technical Parameters

Temperature Range	72 - 240°C
Maximal Voltage	250 VAC
Temperature Tolerance	0 - 10%
Maximal Current	10A (resistive load), 8A (inductive load)

Part No.	T _{OFF} (°C)	T _c (°C)	T _M (°C)
G 4 A 72°C	72	49	100
G 4 A 77°C	77	52	125
G 4 A 93°C	93	68	140
G 4 A 98°C	98	73	140
G 4 A 104°C	104	79	150
G 4 A 110°C	110	82	150
G 4 A 117°C	117	85	150
G 4 A 121°C	121	92	160
G 4 A 128°C	128	103	160
G 4 A 144°C	144	119	175
G 4 A 152°C	152	125	175
G 4 A 167°C	167	142	210
G 4 A 184°C	184	158	210
G 4 A 192°C	192	167	177
G 4 A 216°C	216	200	240
G 4 A 229°C	229	200	240
G 4 A 240°C	240	200	275

T_{OFF} - activation temperature for fuse break (irreversible)

T_c - maximal temperature to contact destroy

T_M - maximal temperature, to fuse destroy

Part No.	Ord. No.
S G 4 A 72°C	40099
S G 4 A 77°C	40100
S G 4 A 93°C	40103
S G 4 A 98°C	40104
S G 4 A 104°C	40105
S G 4 A 110°C	40106
S G 4 A 117°C	40107
S G 4 A 121°C	40108
S G 4 A 128°C	40109
S G 4 A 144°C	40111
S G 4 A 152°C	40112
S G 4 A 167°C	40113
S G 4 A 184°C	40114
S G 4 A 192°C	40115
S G 4 A 216°C	40116
S G 4 A 229°C	40117
S G 4 A 240°C	40119

Bimetallic Thermostats

Bimetallic thermostats (temperature dependant switches) with single contact NC, with 60mm long leads.

AM03/1

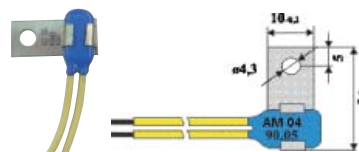

T23, BT-H



AB03

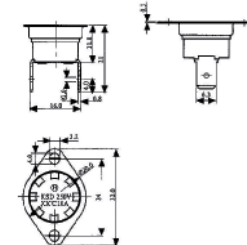
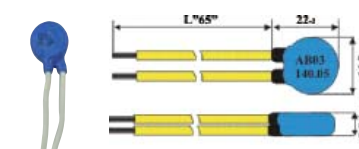

Technical Parameters

Temperature Range	50 - 150°C
Maximal Voltage	250 VAC
Temperature Tolerance	3 - 4%
Maximal Current	10A (resistive load)

Part No.	Contact Type	Current	Activation Temperature (°C)
AB03-90	NC	6,3 A	90
AB03-100	NC	6,3 A	100
AB03-120	NC	6,3 A	120
AM03/1-90	NC	2,5 A	90
AM03/1-100	NC	2,5 A	100
AM03/1-120	NC	2,5 A	120
AM03-90	NC	2,5 A	90
AM03-100	NC	2,5 A	100
AM03-120	NC	2,5 A	120
BT-H70V	NC	10 A	70
BT-H80V	NC	10 A	80
BT-H100V	NC	10 A	100

Part No.	Contact Type	Current	T _{act} (°C)	T _{deact} (°C)
T23A050ASR2-15	NC	10 A	50	35
T23A090ASR2-20	NC	10 A	90	70
T23B090ASR2-20	NO	10 A	90	70
T23A112ASR2-15	NC	10 A	112	97

Part No.	Ord. No.
S AB03-90	58319
S AB03-100	58324
S AB03-120	58328
S AM03/1-90	58309
S AM03/1-100	58313
S AM03/1-120	58317
S AM03-90	58298
S AM03-100	58302
S AM03-120	58306
S BT-H70V	58337
S BT-H80V	58339
S BT-H100V	58340
S T23A050ASR2-15	42786
S T23A090ASR2-20	50627
S T23B090ASR2-20	50636
S T23A112ASR2-15	50631