

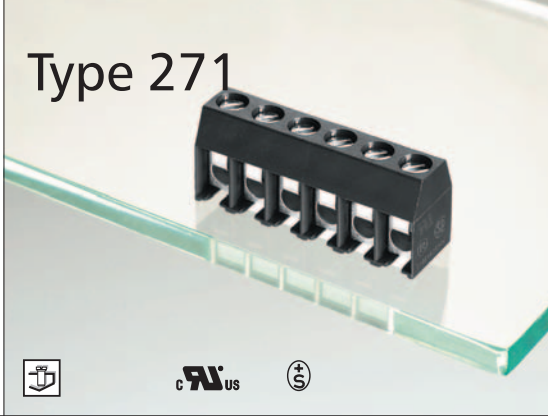

# Type 271

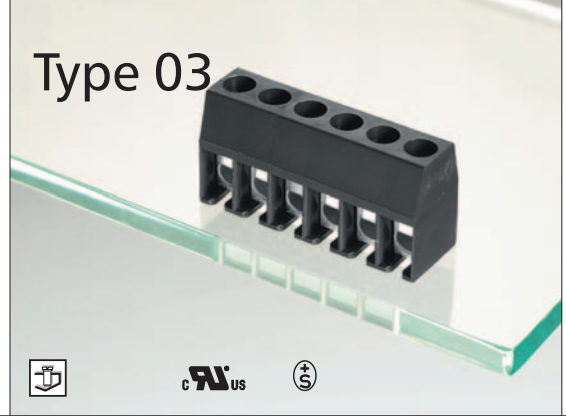

# Type 03



### Note for wire range

Additional wire sizes and/or combinations of same size wires as follows:

#### Type 03

- #(1) Wire range extended to No. 30 AWG for factory-wiring
- + Two same size wires No. 22 - 16 AWG Cu Sol/Str for field-wiring; 30 - 16 AWG Cu Sol/Str factory-wiring

### Description Type 271

Screw type terminal block, solderable, centerline 5 mm / 0.197 inches, horizontal wire entry, wire protector

### Technical Data Type 271

RIA US V / A / AWG 300 / 15 / 26 - 14

Screw torque max. 7 lbs.-in

- Ⓢ 0.08 - 2.5 mm<sup>2</sup> 250 V / 4 kV / 3 / 15 A  
Insulation co-ordination according to IEC 664-1  
Clearance and creepage distance ≥ 3.3 mm  
Screw torque max. 0.5 Nm

Wire diameter	single wire 0.3 - 2.2 mm
Wire strip length	8 mm / 0.315 in.
Solder pin	1 mm / 0.039 in. dia. recommended pc board hole dia. 1.3 mm / 0.051 in.
Solder pin length	4 mm / 0.157 in.
Pole size	2 to 24
Color	black

Dimensions in mm 1 mm = 0.0394 in.

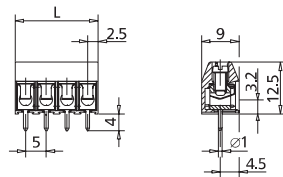

$L = (\text{pole size} - 1) \times \text{centerline} + 5 \text{ mm} / 0.197 \text{ in.}$

### Description Type 03

Screw type terminal block, solderable, centerline 5 mm / 0.197 inches, horizontal wire entry, wire protector

### Technical Data Type 03

RIA US V / A / AWG 300 / 20 / 22 - 12 #(1), + (see note)

Screw torque max. 7 lbs.-in

- Ⓢ 0.08 - 2.5 mm<sup>2</sup> 250 V / 4 kV / 3 / 16 A  
Insulation co-ordination according to IEC 664-1  
Clearance and creepage distance ≥ 3.9 mm  
Screw torque max. 0.5 Nm

Wire diameter	single wire 0.3 - 2.2 mm
Wire strip length	8 mm / 0.315 in.
Solder pin	1 mm / 0.039 in. dia. recommended pc board hole dia. 1.3 mm / 0.051 in.
Solder pin length	4 mm / 0.157 in.
Pole size	2 to 24
Color	black

Dimensions in mm 1 mm = 0.0394 in.

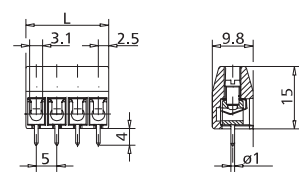

$L = (\text{pole size} - 1) \times \text{centerline} + 5 \text{ mm} / 0.197 \text{ in.}$

### Part numbers (P/N)

#### Type 271

centerline 5 mm / 0.197 inches

P/N 312711

Complete the part number by adding the pole size.

	02	03	04	05	06	07	08
09	10	11	12	13	14	15	16
17	18	19	20	21	22	23	24

#### Type 271

centerline 10 mm / 0.394 inches

P/N 312712

	02	03	04	05	06	07	08
09	10	11	12				

- 02 Standard pole sizes
- 13 Available on demand. Minimum order quantity 5000 poles per item.

### Part numbers (P/N)

#### Type 03

centerline 5 mm / 0.197 inches

P/N 310031

Complete the part number by adding the pole size.

	02	03	04	05	06	07	08
09	10	11	12	13	14	15	16
17	18	19	20	21	22	23	24

#### Type 03

centerline 10 mm / 0.394 inches

P/N 310032

	02	03	04	05	06	07	08
09	10	11	12				

- 02 Standard pole sizes
- 13 Available on demand. Minimum order quantity 5000 poles per item.